

2

1

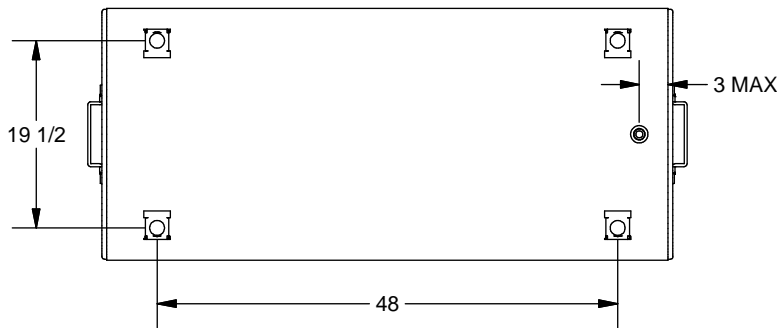
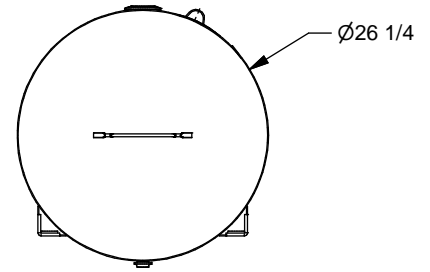
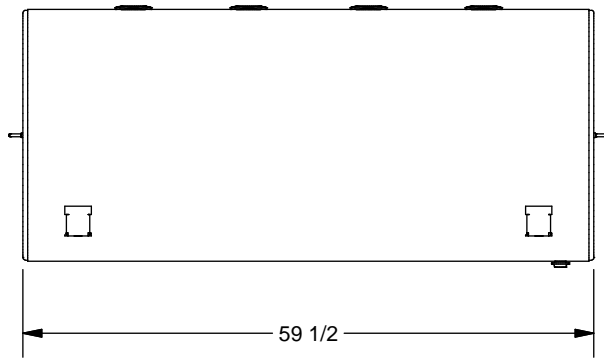
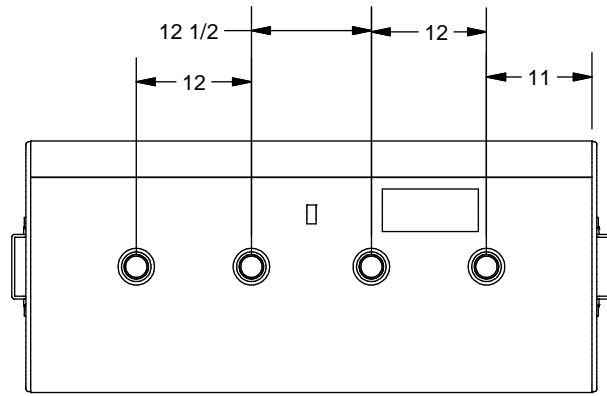

Ce dessin est la propriété exclusive de Industries Granby, SEC. Aucune partie de ce dessin ne peut être utilisée ou reproduite sans sa permission écrite.
 This drawing is the exclusive property of Granby Industries LP. No part of this drawing may be used or reproduced in any manner without its written permission.

TOLÉRANCES LINÉAIRES, LINEAR STD TOLERANCES
 0 OR FRAC. (X/X) -> ±0.5" 0.00 -> ±0.125"
 0.0 -> ±0.25" 0.000 -> ±0.0625"

TOLÉRANCES ANGULAIRES, ANGULAR STD TOLERANCES
 0 -> ± 2 DEG.
 0.0 -> ± 0.5 DEG. 0.00 -> ± 0.1 DEG.

Les soudures doivent respecter la spécification SI-0039.
 Tank welds must respect SI-0039 specifications.

Poids Approx. / Approx. Weight
164 lbmass

Description de la révision / Revision description

Dessiné par / Drawn by
S. Potvin 2017-09-19

Approuvé par / Approved by :

Unités / Units **INCHES** Échelle / Scale Feuille / Sheet **1 / 1**

**Industries Granby S.E.C.,
 Granby Industries L.P.**
 © 2017 Industries Granby, SEC. Granby Industries LP
 Format / Size **A** No de la pièce / Part no. **3005224** REV **D.**

Description / Title
**138 US GAL. 12g HORZ. CYLINDRICAL TANK
 1/2" BELOW BLACK**

2

1

D-TANK_TMPLT-E